

Section A-A

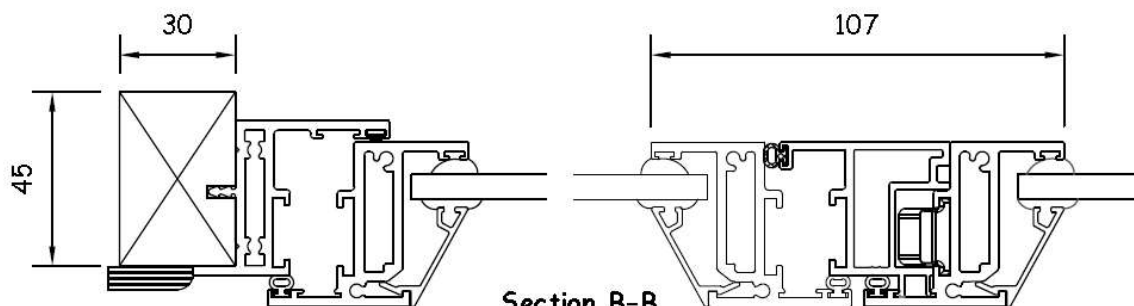
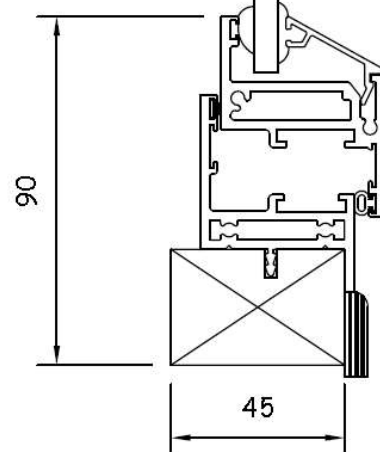

Section B-B

Flying mullion
(can be left or right hand master)

Optional Extras

locking handle
Small locking handle
concealed hinges
restrictor catch
Tilt & turn gearing
full anti-ligature spec
Actuator handle
Trickle vents / acoustic trickle vents (in sash)
RAL colour
Timber sizes other than standard

Specification:

Aluminium 6063T6 alloy to BS EN 755 standard, powder coated to BS 6496 to 60 micron finish.

Stock finishes: White - Interpon SA 098E high gloss,

The sub-frame is manufactured from primed high quality, environmentally certified (MTCS) engineered timber. Standard sizes 45mm x 30mm & 62mm x 30mm.

All frames are factory glazed.

Standard gasket colour is black.

All frames include pvc-u trim as standard - Painted MDF or PEFC timber available upon request.

In line with our company policy of continuous product development and improvement, Clearview reserves the right to make minor alterations to specification without notice.

Type: **Forte Double Hinged Unit. Facel Fix.**

Date: 30/3/2015

Dwg. No. HDHU FF

Scale: 1:20 & 1:2 (at A4)



EMAIL: info@clearviewsg.co.uk
TEL: 0114 294 5018