

Section B-B

Double Glazed Sealed Unit Example

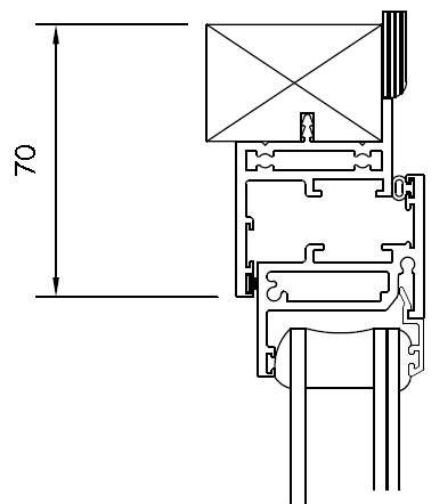

Section A-A

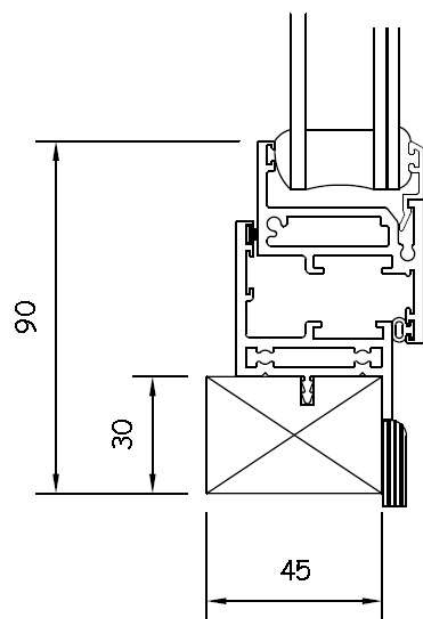

Specification:

Aluminium 6063T6 alloy to BS EN 755 standard, powder coated to BS 6496 to 60 micron finish.

Stock finishes: White - Interpon SA 098E high gloss, brown - van dyke and silver anodised.

The sub-frame is manufactured from primed high quality, environmentally certified (MTCS) engineered timber. Standard sizes 45mm x 30mm & 62mm x 30mm.

All frames are factory glazed.

Standard gasket colour is black.

All frames include pvc-u trim as standard - Painted MDF or PEFC timber available upon request.

In line with our company policy of continuous product development and improvement, Clearview reserves the right to make minor alterations to specification without notice.

Optional Extras

locking handle

Small locking handle

concealed hinges

restrictor catch

Tilt & turn gearing

full anti-ligature spec

Actuator handle

Trickle vents / acoustic trickle vents (in sash)

RAL colour

Timber sizes other than standard



EMAIL: info@clearviewsg.co.uk
TEL: 0114 294 5018

Type: **Forte Hinged Unit
Double Glazed Face Fix**

Date: 30/1/2013

Drg. No. HHU FF DG

Scale: 1:20 & 1:2 (at A4)