

Section A-A detail.

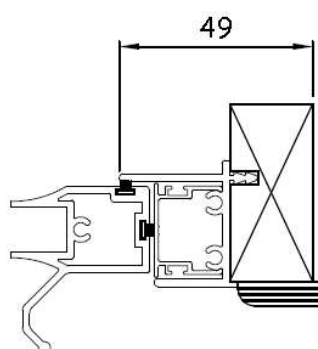
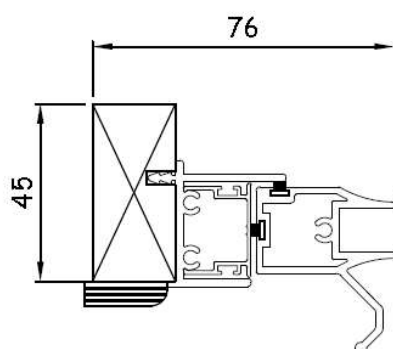
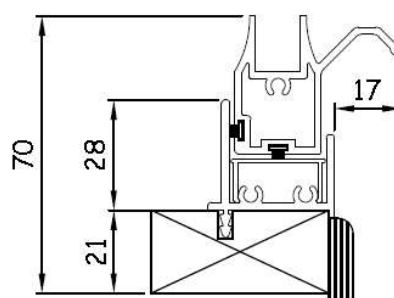

Section B-B detail.

Specification:

Aluminium 6063T6 alloy to BS EN 755 standard, powder coated to BS 6496 to 60 micron finish.

Stock finishes: White - Interpon SA 098E high gloss, brown - van dyke and silver anodised. The sub-frame is manufactured from primed high quality, environmentally certified (MTCS) engineered timber. Standard sizes 45mm x 30mm & 62mm x 30mm.

All frames are factory glazed.

Standard gasket colour is black.

All frames include pvc-u trim as standard - Painted MDF or PEFC timber available upon request.

In line with our company policy of continuous product development and improvement, Clearview reserves the right to make minor alterations to specification without notice.

Lift Out

Optional Extras

white gasket
white aluminium coupling / stacking interlock
Trickle vents / acoustic trickle vents
RAL colour
flyscreen
Timber sizes other than standard



Type: Forte Slim Lift Out 45mm Timber Face Fix

Date: 30/3/2015

Drq. No. Forte Slim Lift Out 45mm Timber FF

Scale: 1:20 & 1:2 (at A4)

EMAIL: info@clearviewsg.co.uk
TEL: 0114 294 5018