

Double Hinged Unit DHU

Panel Opening Orientation

- Fixed Frame with self-contained Double Hinging Casements
- Flying Mullion – No fixed central pillar
- Left (LH) Primary side Opener / Right (RH) Primary side Opener
- Butt Hinges 180° opening
- Casement cannot be removed
- Single Key-Lock Handle (espag)– Internal multipoint locking



Key Locking Handle

Technical Information

Composition: Timber, Aluminium & Glass

Panel Configuration

Double Panels, self-contained within a fixed outer frame, opening inward. Opening can be selected to the left side being the primary access side, the right as the secondary or right sided orientation. Butt Hinges for 180° opening capability. Single espag style key locking operating handle with multipoint locking feature and compression seals. Full double door opening with no fixed centra pillar. Optional extra tilt and turn gearing system to the primary opener.

Panels removable

No, orientation, i.e. LH Lefthand or RH Righthand must be selected at point of order, not retro adjustable.

Unit Build Size

Min 759mm x 475mm

Max. 4mm glass 3000mm x 1800mm, 6mm to 10.8mm glass 3000mm x 3000mm

Ultra-Panel glass 28mm sealed double glazed unit Max 3000mm x 3000mm (note weight management)

Maximum Panel weight 100kgs

Glass

Standard glass 4mm toughened – Standard frame maximum glass thickness 6.8mm

Ultra-Panel glass thickness: up to a 28mm sealed double glazed unit.

Thermal Performance: Variable

Standard 2.7 wm^2K / *Low-E DGSU 1.0 wm^2K

Acoustic Performance: Variable

Mid-Range Spec* 48dB / High spec 54dB

Specification

- Aluminium 6063-T6 alloy BS EN 755-9 standard, power coated to BS 6496 to 60 - 80-micron finish
- Stock finish: White – RAL 9003 Satin.
- Finishing Trim included: 20mm White PVC-U single bullnose trim as standard. Painted PEFC timber available with colour units or upon request.
- The Sub-Frame Primed high quality 2-coats, FSC Mix credit radiata pine clear grade, FSC mix credit TT-COC-002 157.
- Standard Sub-Frame sizes 50mm x 16mm & 70 mm x 16 mm.
- All Frames are factory glazed.
- Standard gasket colour is white.
- Key locking handle.

In line with our company policy of continues product development and improvement Clearview reserves the right to make minor alterations without notice.

Optional Extras

- Black Gasket
- Tilt & Turn Gear – fixed/secure unobtrusive ventilation setting.
- Casement opening restrictor
- Multi-unit coupling section for stacking connecting.
- Low Threshold 12mm frame section to bottom and/or top.
- Trickle vents / acoustic trickle vents
- RAL colour options
- Wider finishing trim options
- Timber bevelling for splayed reveals and bay formation. – *see options below*
- Timber sizes other than standard

Frame Details

Standard
Sub-Frame
50 x 16mm



XL
Sub-Frame
70 x 16mm

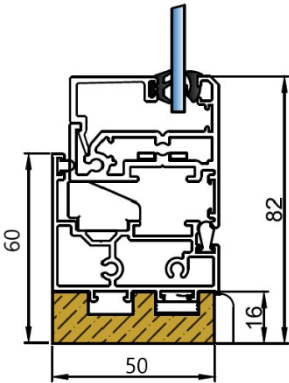

Standard Frame

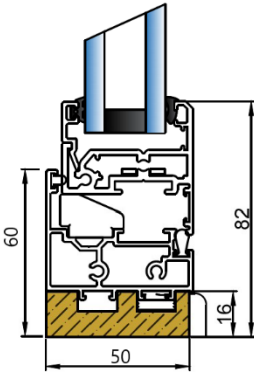

Standard Frame
Ultra-Panel

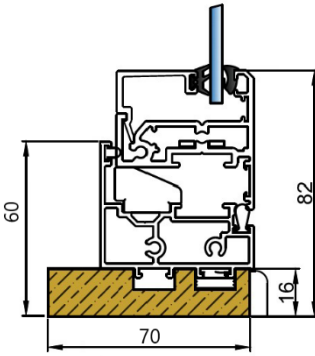

XL Frame

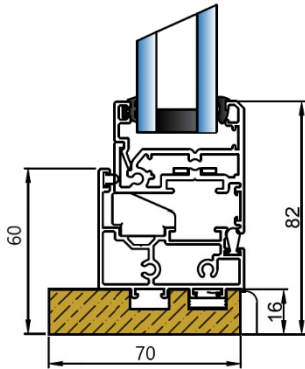

XL Frame
Ultra-Panel

Fixing Options



Face Fixing:
Pre-drilled
Front-to-Back



Reveal Fixing:
Track Drilled on
site by installer.



Reveal Fixing:
Pre-drilled
through XL timber

Images are for representation purposes only and may differ from some product options.

DHU - Standard Frame Diagram

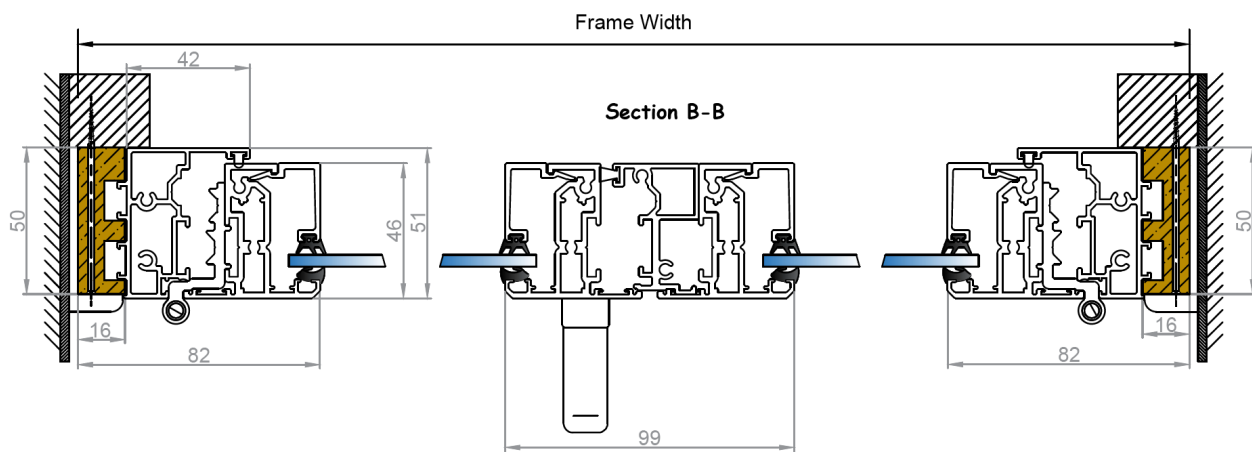
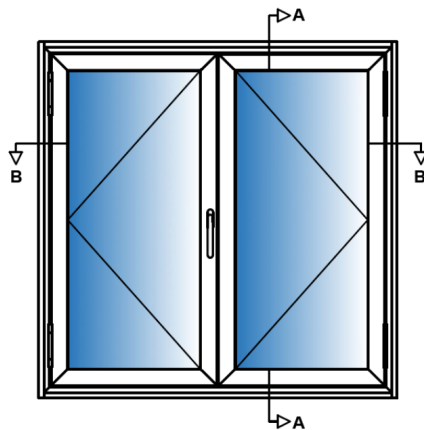
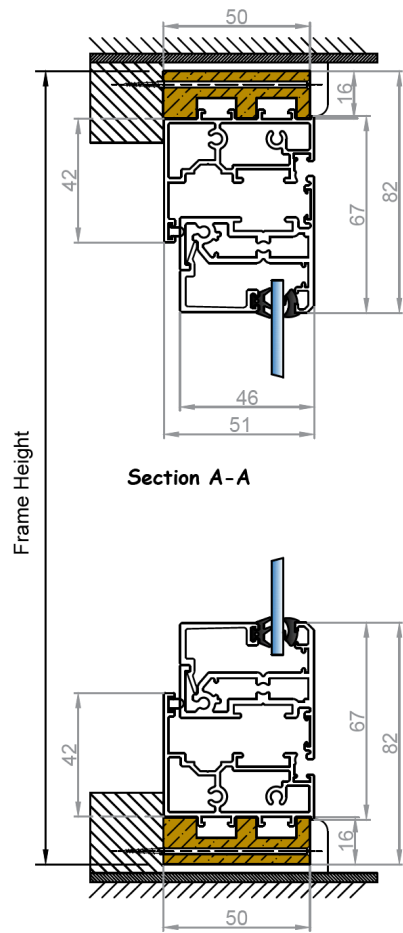

DHU - XL Frame Diagram

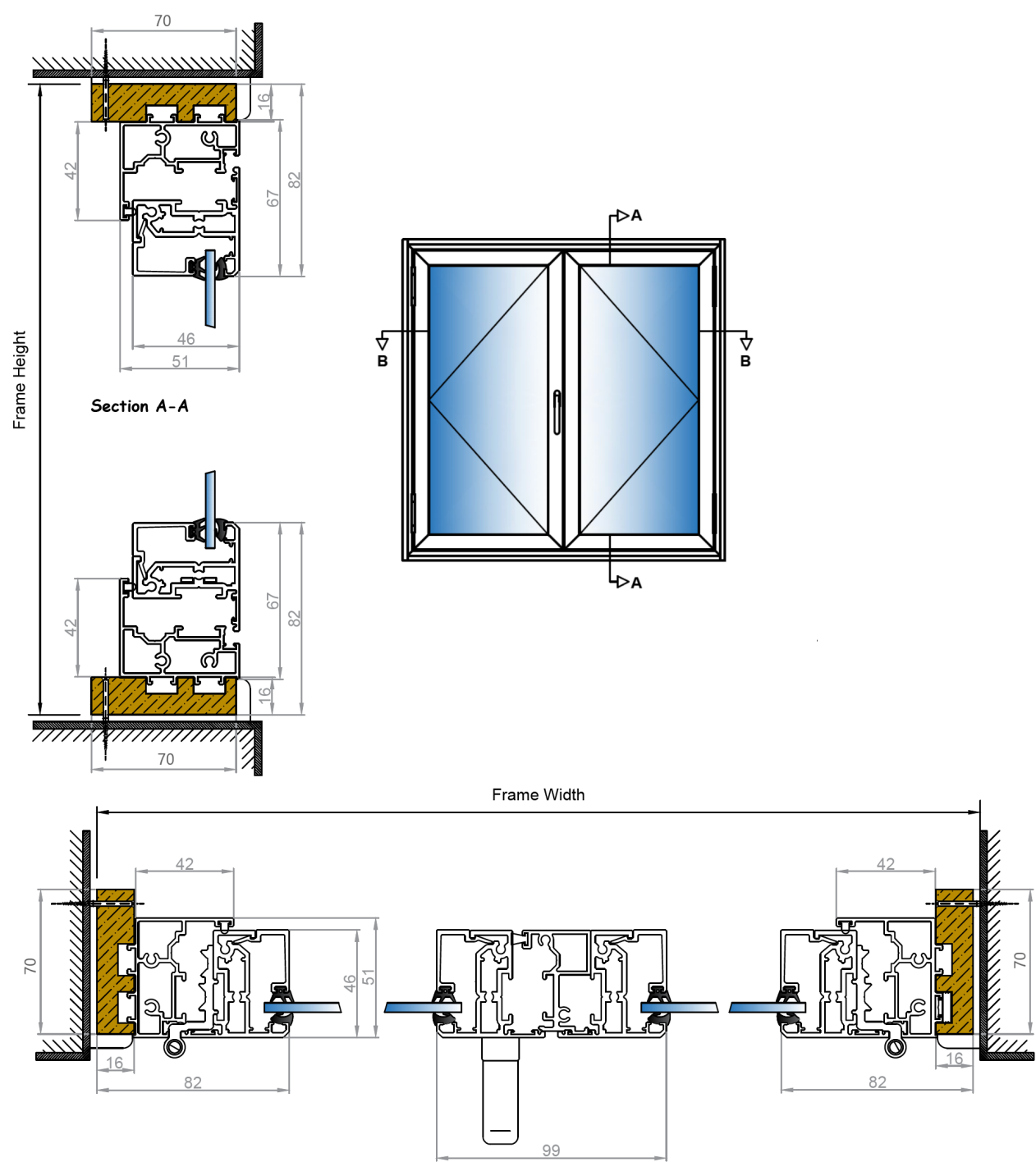

DHU - Ultra Profile Diagram

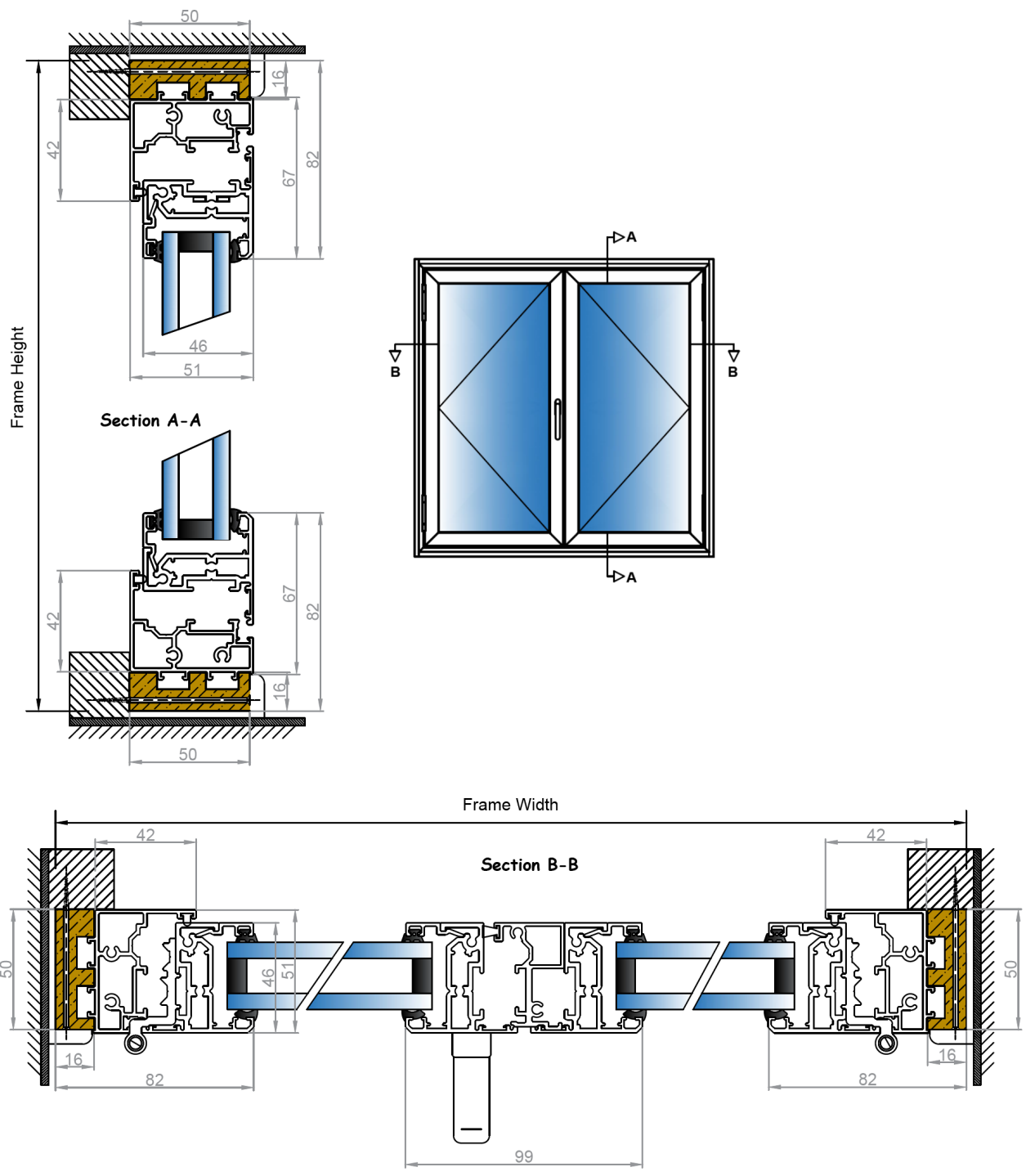

DHU - Ultra XL Profile Diagram

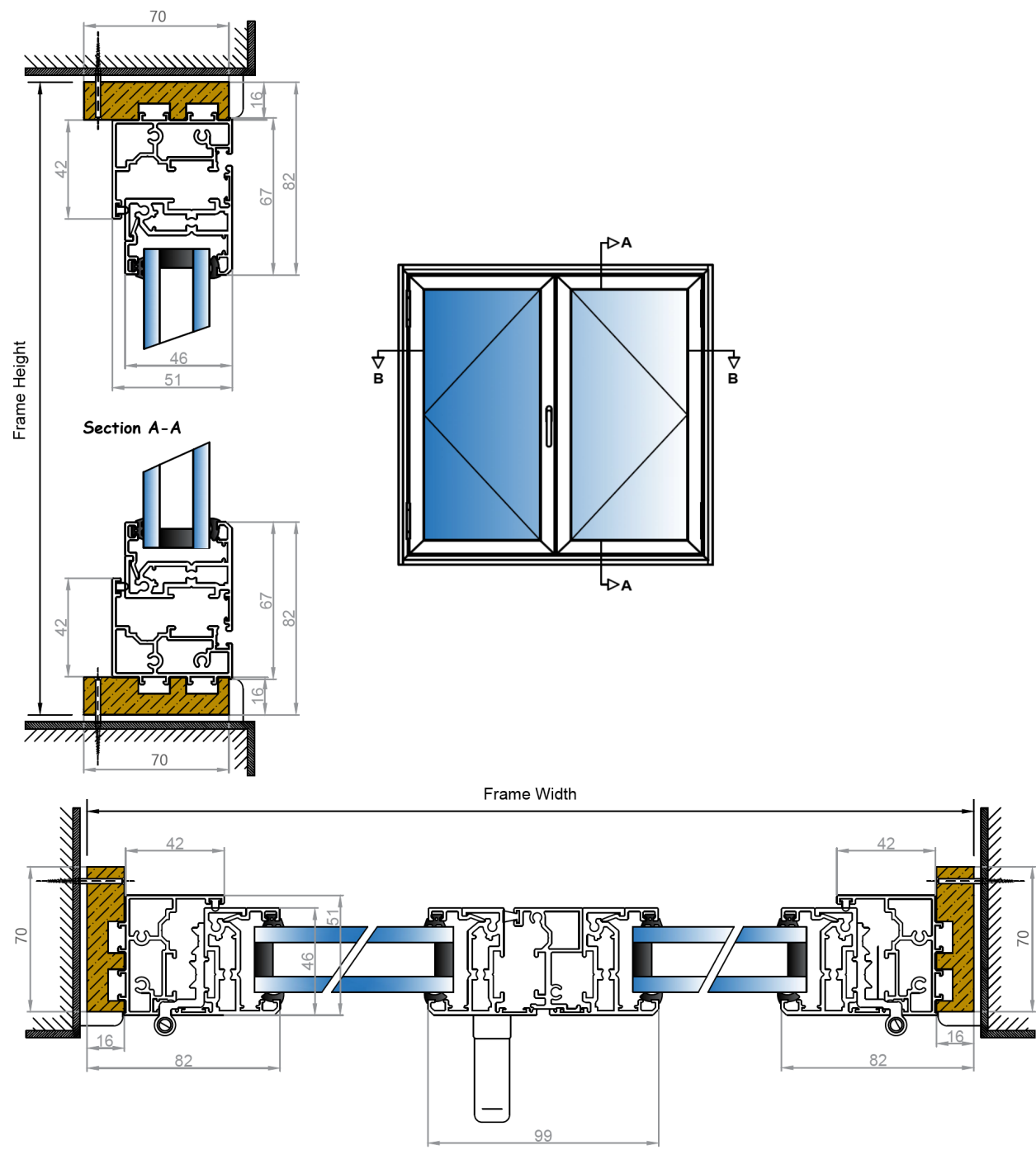

DHU - Low threshold example

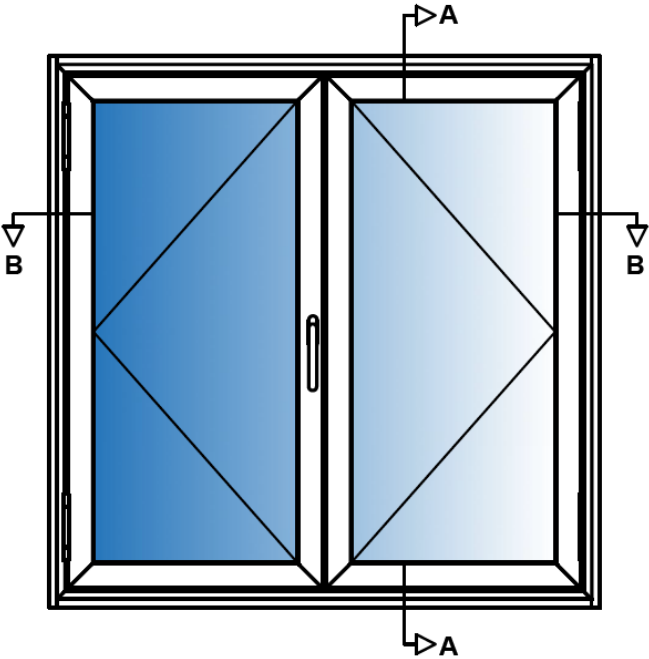
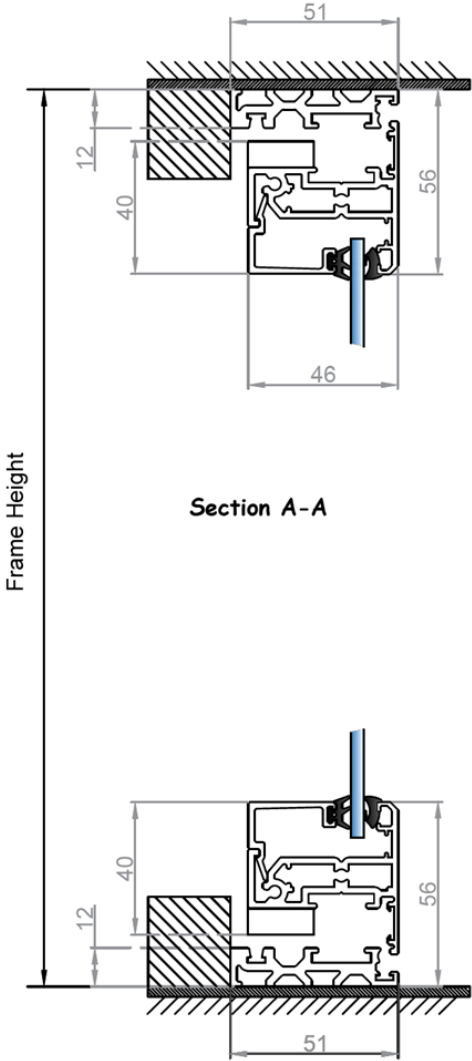

Low Threshold Top & Bottom Profile Only

Timber Modification Options



Standard Timber Option



XL Timber Option



Bevelled Timber for Splayed Reveal



Example of Splayed Reveal



Angled Bay Bevelled Timber

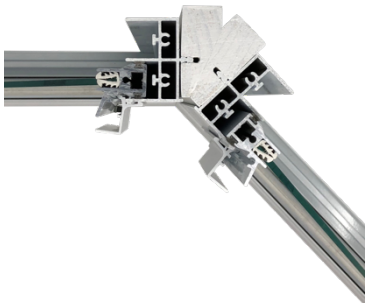

Angled Bay Connected Timbers

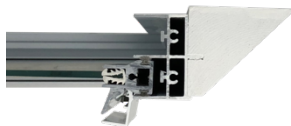

Square Bay Bevelled Timber

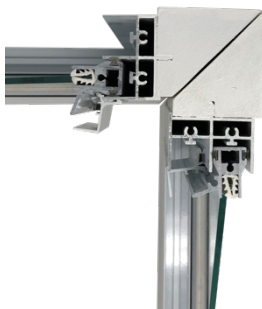

Square Bay Connected Timbers

Frame Shape Options

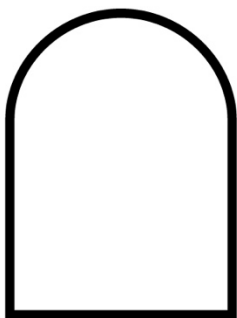

Standard Arch

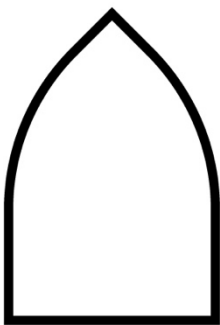

Gothic Arch

Templates may be required from the customer



Please get in touch with one of our friendly team today for help & advice.



Online Help Centre
[Visit our Online Help Centre >>](#)



Fast Quote
[Get a fast quote online >>](#)



Email
info@clearviewsg.co.uk



Phone
0114 294 5018