

#### Specification

Aluminium 6063-T6 alloy to BS EN 755-9 standard, powder coated to BS 6496 to 60 – 80 micron finish.

Aluminium Finish: White – RAL 9003 Satin.

Sub-Frame: Primed high quality with 2 coats, FSC Mix credit radiata pine clear grade, FSC mix credit TT-COC-002 157.

Timber Size: 62mm x 16mm.

Glazing: All frames are factory glazed.

Gasket colour: White.

Trim: 27mm uPVC Single Bullnosed White.

Ironmongery: Integrated button included.  
Locking button as a extra option.

Reverse option also available

In line with our company policy of continuous product development and improvement, Clearview reserves the right to make minor alterations to specification without notice.

Frame Height

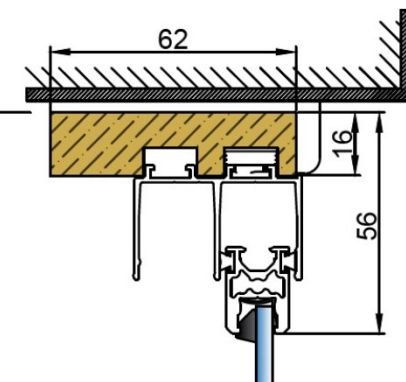

Section A-A

Frame Width

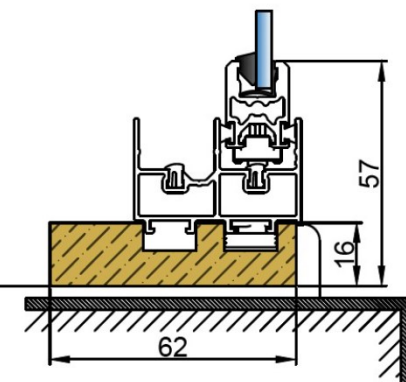
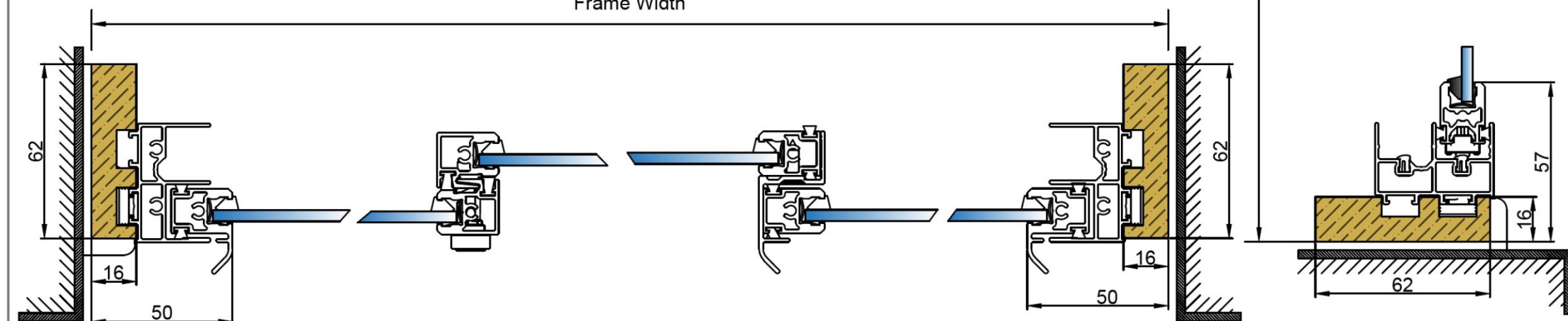

PROJECT:

Vision 3 Panel Horizontal Slider XL - CO3RH

GSG\_001

DRAWING NO.

-

PROJECT NO.

07/07/21

DATE.

TITLE:

HS3-XL: XL 3-Panel Horizontal Slider - Max Glass thickness 6.8mm

NTS

AB

DRAWN.

RH

CHECKED.

-

REVISION.



EMAIL: info@clearviewsg.co.uk  
TEL: 0114 294 5018